

# CC Control Enclosures

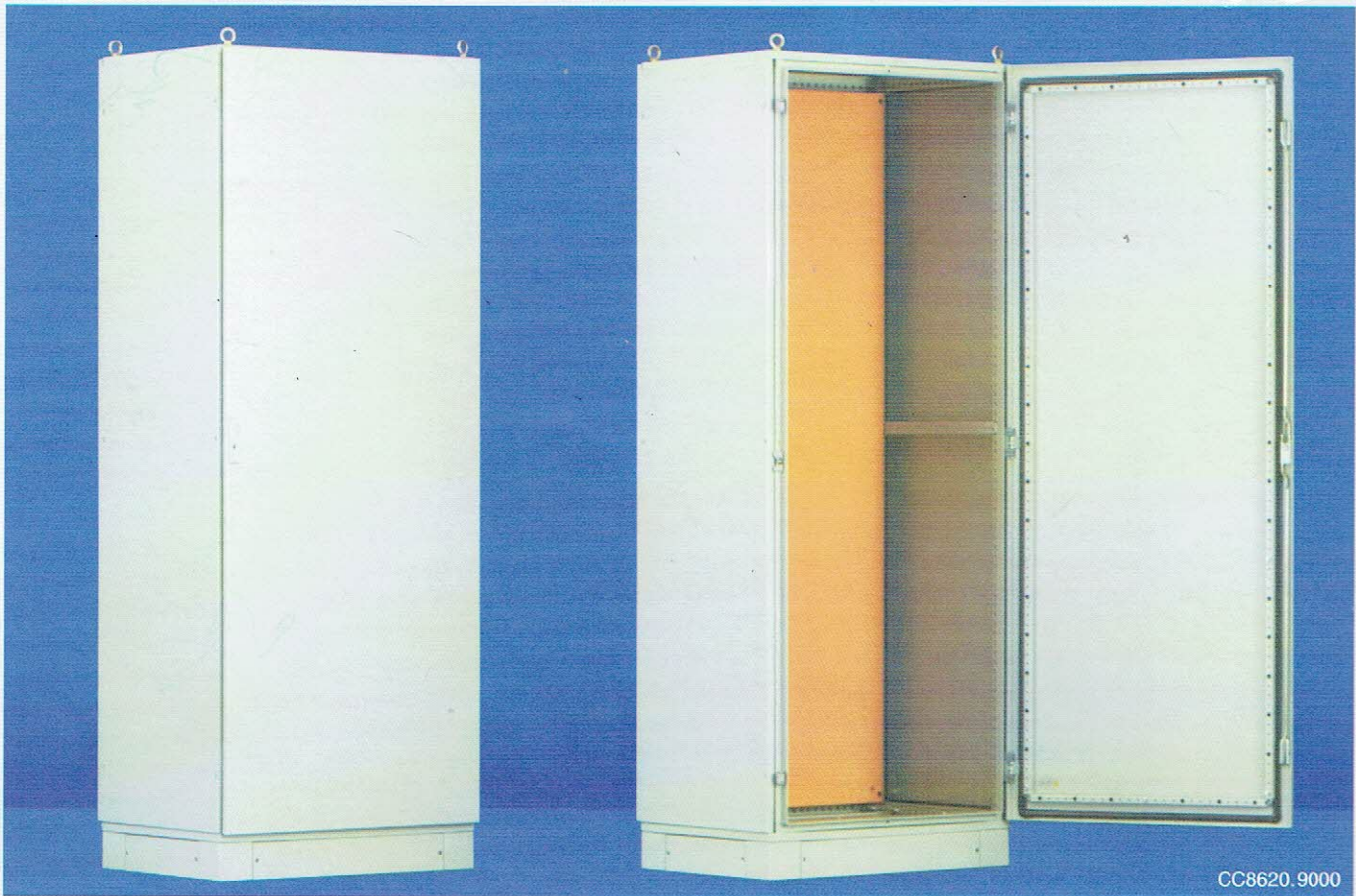

CC8620.9000

## Feature:

- Strong and stable profiled bar with prepared mounting holes (integrated size: 25mm);
- Stable structure, exquisite image, spacious inner mounting space, common used accessories;
- Three point bolted luxury lock, side panels (optional) and back panels are fixed by screws;
- Door can be open to 130 degrees, open left or right freely;
- All-round Polyurethane Gasket between door and Frame with good sealing performance;
- 3-sectioned bottom panel, easy to enter cables;
- M8 earthing pole mounted on the body, door and the mounting panel;
- A whole mounting panel, can be adjusted.

## Degree of protection:

- Comply with IEC60529, EN60529/10.91 and GB4208-93 standard, IP55.

## Material:

- SPCC cold rolled steel ;
- Thickness: mounting panel: 2.5mm, front door: 2.0mm; frame: 1.5mm; others: 1.2mm.

## Surface finish:

- Body of enclosure, frame & doors:  
Degreasing, phosphoric, powder coated, static powered with textured stove enamel RAL7035 ;
- Mounting panel ( SPCC cold rolled steel):  
Degreasing, pickling, phosphoric, powder coated, static powdered with flat coating RAL2000.

## Use:

- Available for mounting various industrial component, controlling and cables entry.

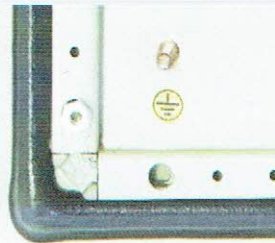

Polyurethane Gasket & Earthing kit



3-sectioned bottom panel

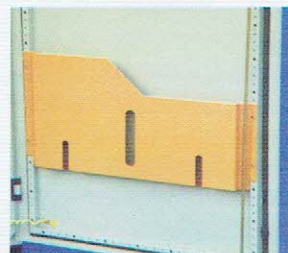

Data pocket (optional)

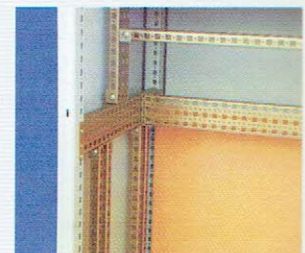

Various horizontal Mounting angles (optional)

Structure

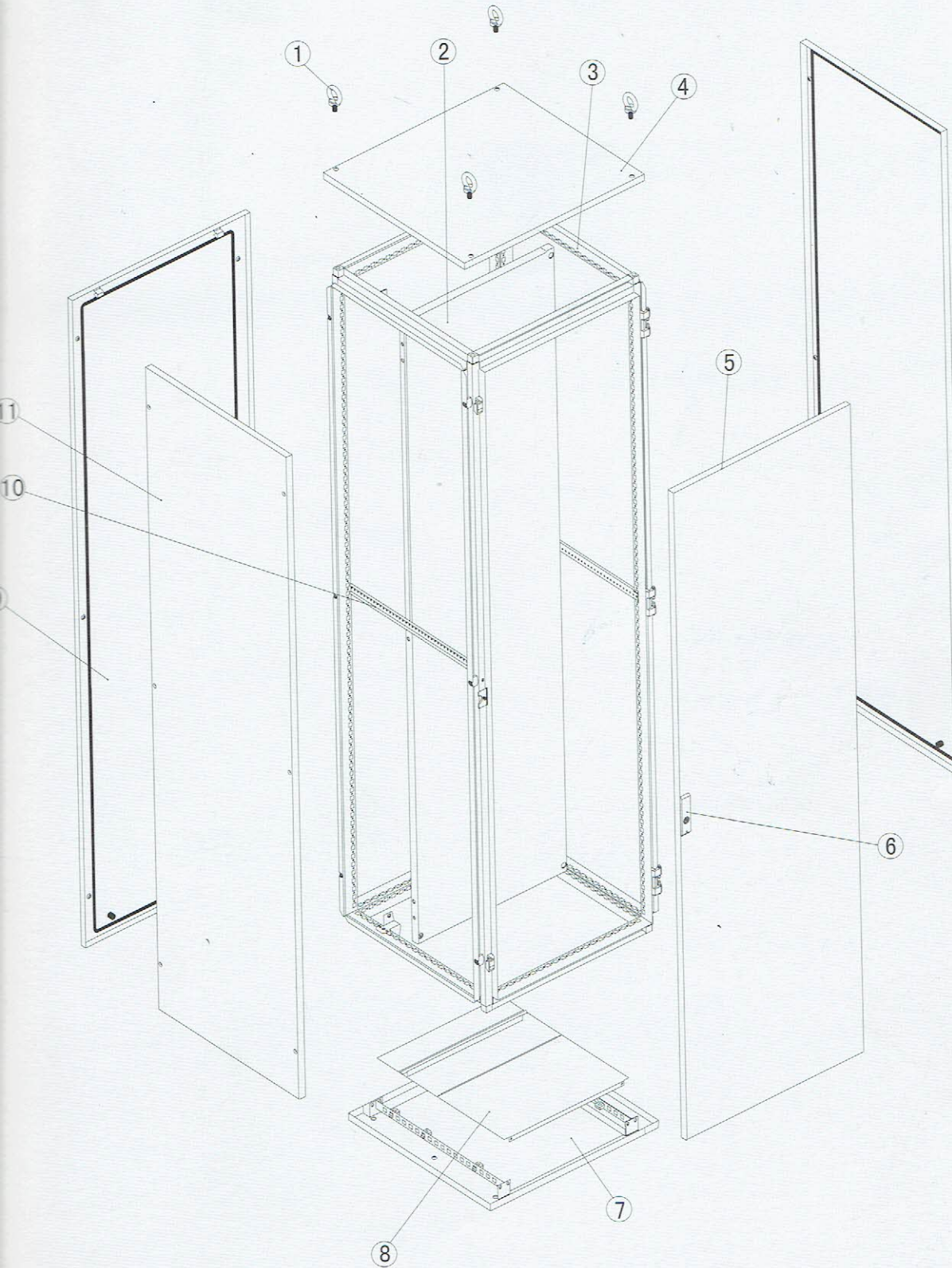

2. Mounting panel

3. Frame

4. Top cover

5. Front door

6. Lock

7. Bottom panel

9. Back panel

10. Mounting angle

11. Side panel (optional)

11. Side panel (optional)  
8. Bottom panel cutaway

TD  
hang  
↑

## Main dimension

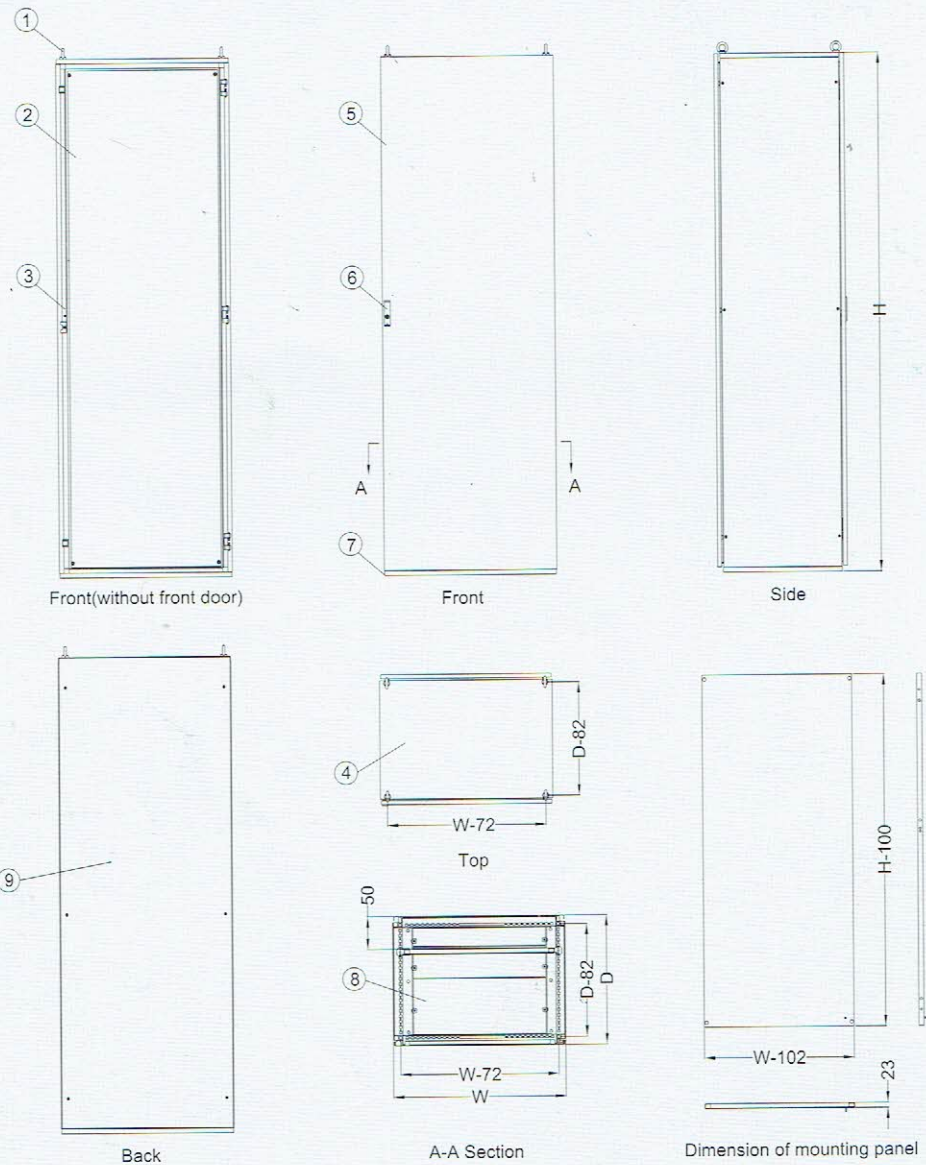

## Main parts:

S/N	Specification	Quantity	Unit	Material	Surface Finish	Remark
1	Eye bolt	4	Piece	Steel	Color Zinc	---
2	Mounting panel	1	Piece	SPCC cold rolled steel t2.5	Powder coated	---
3	Frame	1	Set	SPCC cold rolled steel t1.5	Powder coated	---
4	Top cover	1	Piece	SPCC cold rolled steel t1.2	Nickel coated	---
5	Front door <sup>①</sup>	1	Piece	SPCC cold rolled steel t2.0	Powder coated	Single-section front door
6	Lock	1	Piece	---	---	With 1 key
7	Bottom panel	1	Piece	SPCC cold rolled steel t1.2	Powder coated	---
8	3-sectioned bottom panel	1	Set	SPCC cold rolled steel t1.2	Powder coated	---
9	Back panel	1	Piece	SPCC cold rolled steel t1.5	Powder coated	---
10	Mounting angle	2	Piece	SPCC cold rolled steel t2.0	Powder coated	---

**Remarks:** ① Width over 1000MM enclosures is with double-section front door.